

1 SCOPE

This instruction can be used for these toolkits / spare part repair kits:

9515121	Toolkit for pitch cylinder Item 20012342	For 5066609;5066492;5067091,5066813S
5201261L	Repair kit Light	For 5066609/5066492/5067091 V80 (29079541)
5271802H	Repair kit Heavy	For 5066609/5066492 V80 (29079542)
5201261H	Repair kit Heavy	For 5067091 (29079543)
5271936L	Repair kit Light	For 5066813
5271936H	Repair kit Heavy	For 5066813
9515135	Toolkit kit for pitch cylinder	For 5056412
5200695H	Repair kit Heavy	For 5056412 (29079580)
5200695L	Repair kit Light	For 5056412 (29079582)

2 DISASSEMBLY

Before disassembly, the system must be in safe mode, pressureless and the cylinder drained for oil. Prepare for oil collection when dismounting valve block, pipes, and cylinder enclosure.

2.1 POSITIONS SENSOR

Unscrew and pull the position sensor out of the cylinder. Mount the drain hose 34762 in the hole.

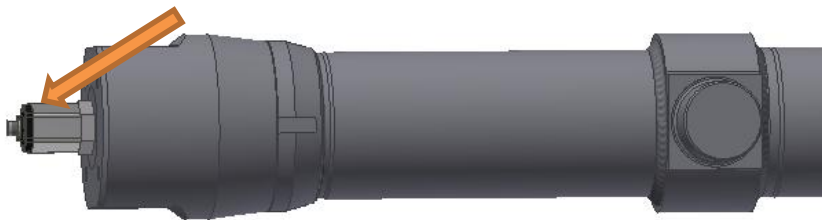

2.2 BEARING HEAD

2.2.1 Bearing head without pretension flange

Measure the distance between the piston rod and bearing head.

Loosen all the bolts in the clamping bearing head:

Widen out the clamping by mounting plate chisels in the slots on each side.



2.3 GLAND

Mount the nylon plug in the B-port.

Use the plug 59 mm on this type of cylinder.

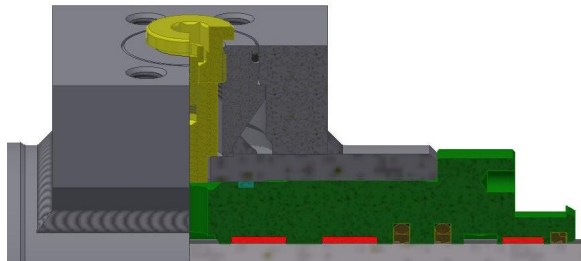

Use the plug 39 mm on this type of cylinder.

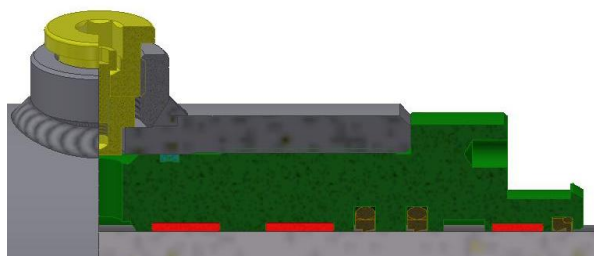

Remove the paint in the gap between the counter nut and tube.

GLUAL: Remove the stopscrew between the gland and tube.

Use the torque multiplier with the special socket to unscrew the gland, as shown below.

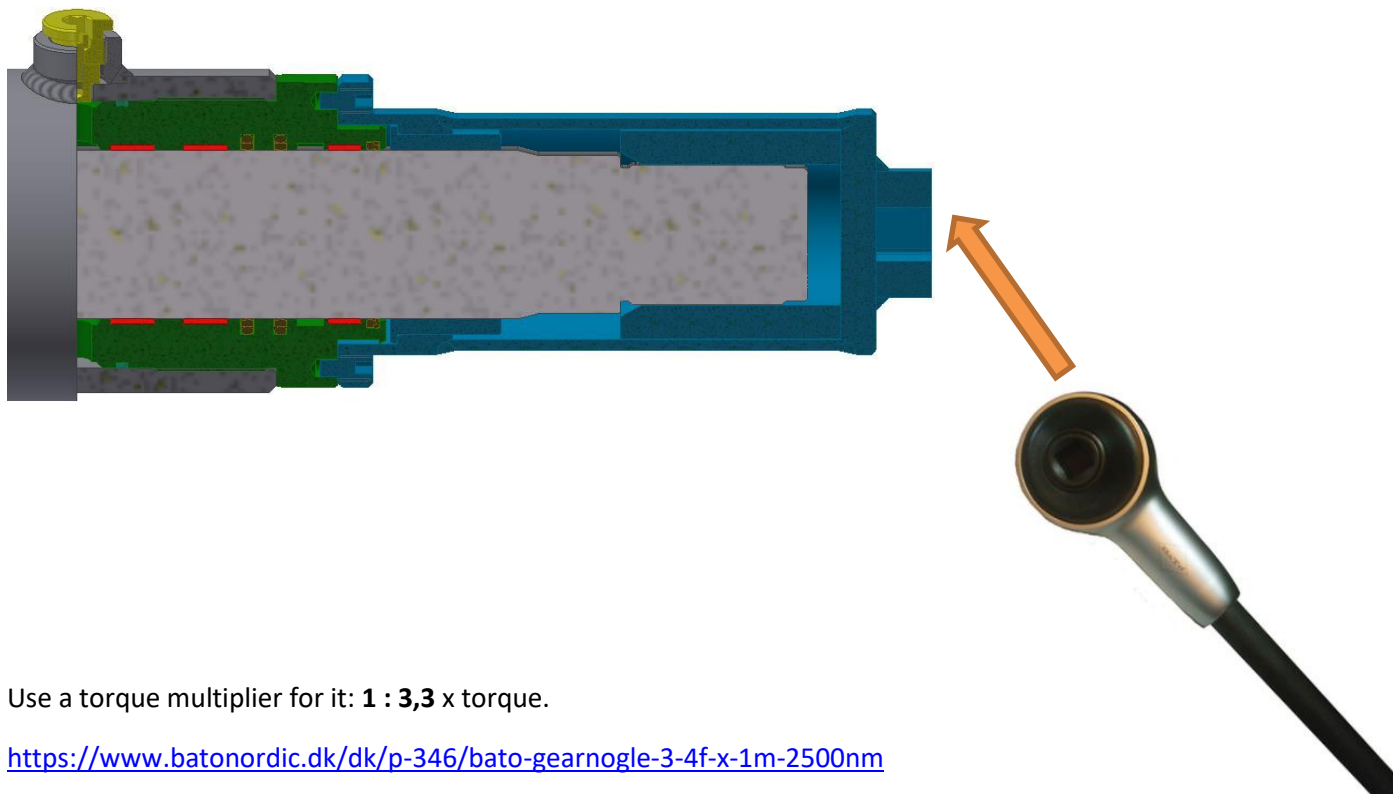

Use a torque multiplier for it: **1 : 3,3** x torque.

<https://www.batonordic.dk/dk/p-346/bato-gearnogle-3-4f-x-1m-2500nm>

If Light repair: screw the assembly bush on the rod end.

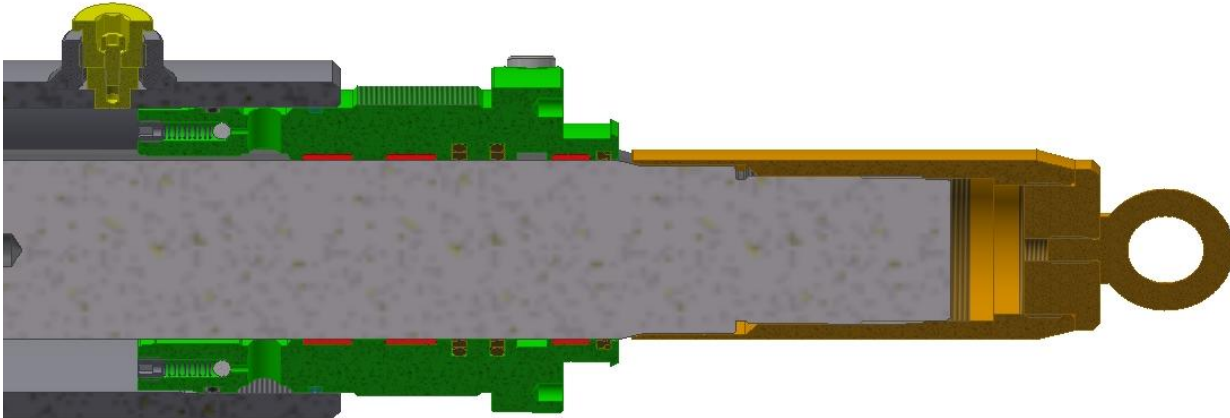

Slide the gland over the rod end assembly bush, as shown below. Check the rod for scratches. Mount the new pre-assembled Light repair gland on the rod.

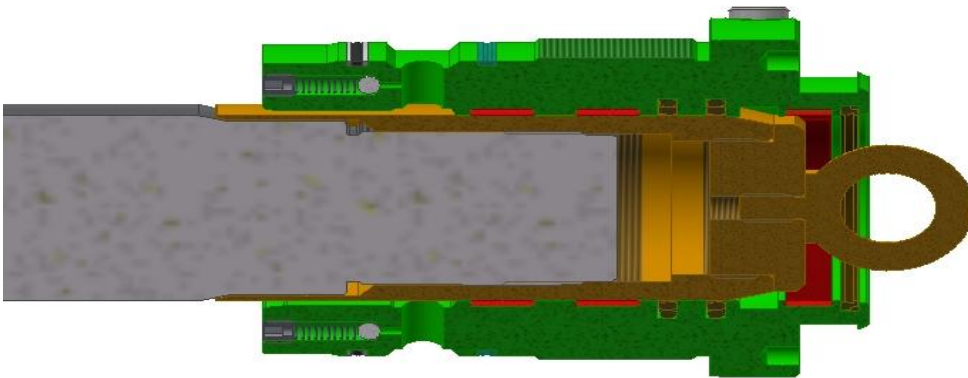

2.4 PISTON if light repair kit:

Pull the rod with piston and gland out of the tube.

Cut the piston seal with a Stanley knife. (Be carefully not to damage the piston).

Mount new guide rings and piston seal. Use the piston assembly bush as shown below. Mount calibration bushing over piston seal, and keep it there for than 15 min.

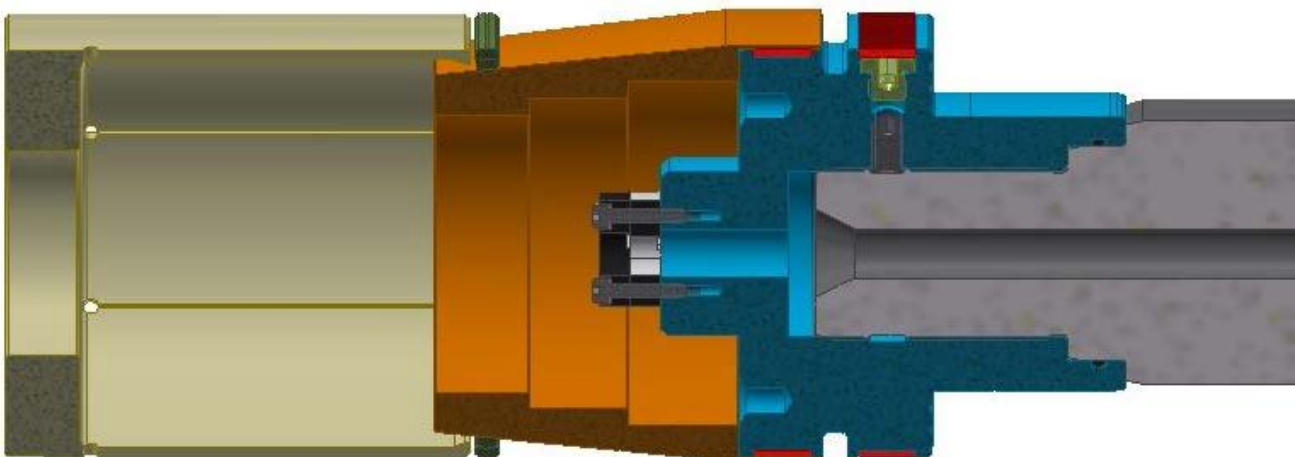

3.2 Assembly

Make sure the nylon plug is still installed in the B-port.

Slide the Piston rod and gland into the tube, be carefull not to touch the tread with the seal on the piston screw it into the tube, and tighten it with 950 Nm.

[All as shown in section 2.3, just in reverse order.]

3.4 POSITIONS SENSOR

Reinstall position sensor in cylinder. Tighten with 80 Nm.

3.3 BEARING HEAD

3.3.1 Bearing head without pretension flange

Grease on the thread before screw the bearing head on the rod end with the chisels still sitting in the slots.

Use tools show in section 2.2.1

Adjust it into position and remove the chisels.

Tighten all the clamping bolts.

3.3.2 Bearing head with pretension flange

Mont flange, screw and bearing head on the rod end.

Adjustment of bearing head (cylinder length at full stroke) to match blade lock, according to WTG manufacturer instruction.

Use tools show in section 2.2.2 and apply pretension according to WTG manufacturer instruction.

3.5 END ASSEMBLY / INSPECTION

Mount valve block, pipes, and all other disconnected parts.

Drive the cylinder full stroke 5 times between 5-85° without load, to bleed air out of the system. Test the cylinder under full pressure and check for tightness.



4 TOOL KIT NO. 9515121 - VESTAS VT20012342

Reservedelsliste - Spare Part List - Ersatzteilliste						
Pos.	Stk. Pcs. Stück	Vare nr. Item. no. Warennr.	Beskrivelse	Description	Beskrivelse	
10	1	5271818	Montagebøsning f. Ø80 mm Stang	Assembly bush f. Ø80 mm Rod	Montagebuchse f. Ø80 mm Stab	
20	1	5271817	Montagebøsning f. Ø125 mm M-sko	Assembly bush f. Ø125 mm piston	Montagebuchse f. Ø125 mm stempel	
30	1	5271822	Nylon Montagebøsning f. Ø125 mm M-sko	Nylon Assembly bush f. Ø125 mm Piston	Nylon Montagebuchse f. Ø125 mm Stempel	
40	1	31725	O-ring 5,7x119,3	O-ring 5,7x119,3	O-ring 5,7x119,3	
50	1	5271819	Montagenøgle	Mounting key	Montageschlüssel	
60	1	5271827	Montagetop Ø104x228;DC=Ø127	Mounting top Ø104x228;DC=Ø127	Montagetop Ø104x228;DC=Ø127	
70	1	5271883	Kalibreringsbøsning ø125	Calibration bushing ø125	Kalibrering Buchse ø125	
80	1	5272300	Nylonblændprop 3/4" RG sæt Ø12,5x9,9	Nylon plug 3/4" RG set Ø12,5x9,9	Nylonstøpsel 3/4" RG set Ø12,5x9,9	
90	1	5271832	Nylonblændprop 3/4" RG sæt Ø12,5x8,4	Nylon plug 3/4" RG set Ø12,5x8,4	Nylonstøpsel 3/4" RG set Ø12,5x8,4	
100	1	9515166	Montagenøgle for AF=68	Mounting key for AF=68	Montageschlüssel für SW=68	
110	1	9515165	Flangelås for (29082565) Ø90x50-PA6	Flange lock for (29082565) Ø90x50-PA6	Flanschsperr (29082565) Ø90x50-PA6	
120	1	9515149	Montagenøgle for flange (29082565)	Mounting key for flange (29082565)	Montageschlüssel Flansch (29082565)	
130	1	34762	Slangesæt for olietømning	Oil drain hose kit	Ölablassschlauch-Kit	
140	2	63295	Mejsel 1	Chisel 1	Meißel 1	
150	2	63065	Mejsel 2	Chisel 2	Meißel 2	

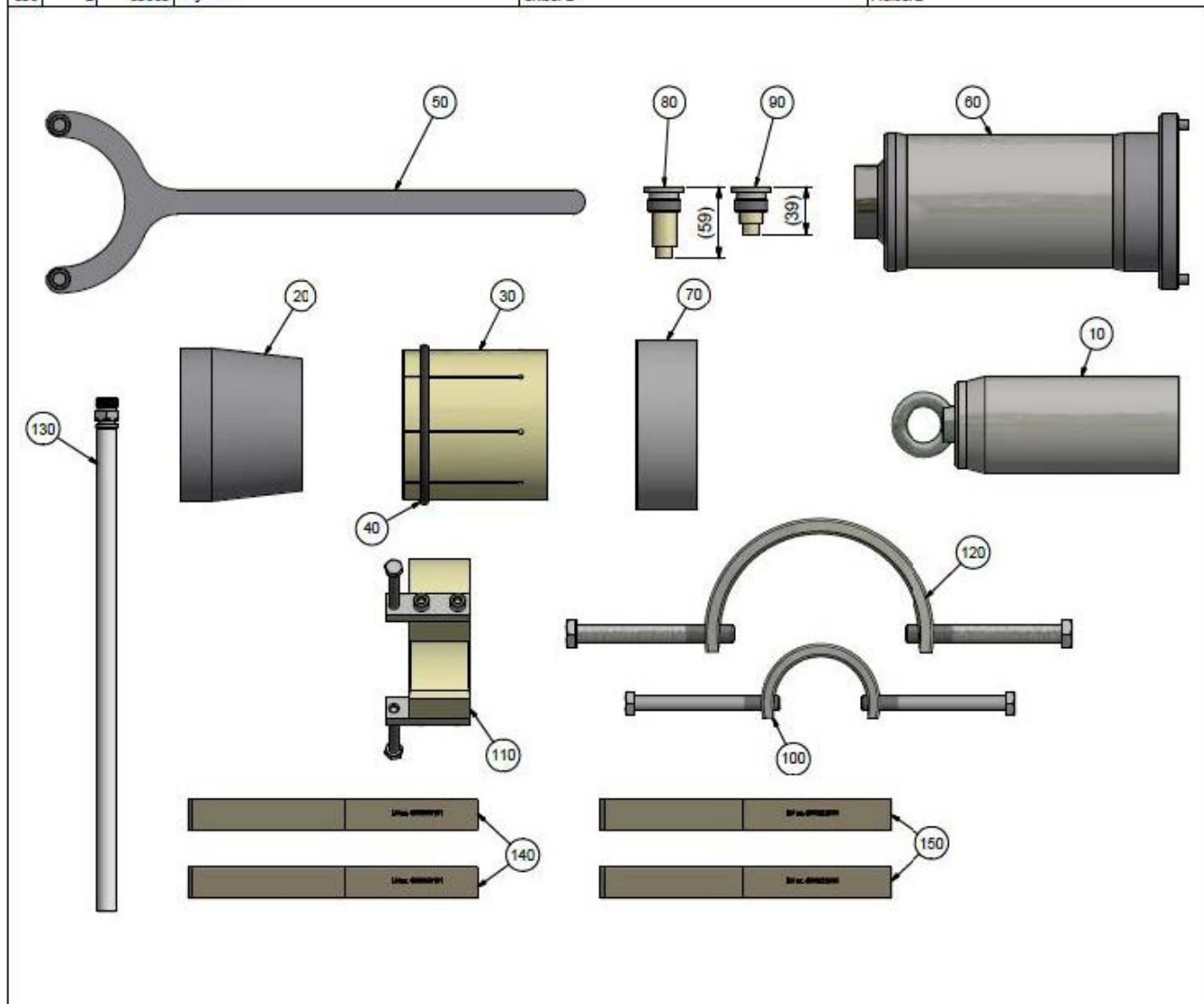



5 TOOL KIT NO. 9515135 (FOR 5056412) - VESTAS VT

Reservedelsliste - Spare Part List - Ersatzteilliste

Pos.	Stk. Pcs. Stück	Vare nr. Item. no. Warennr.	Beskrivelse	Description	Beschreibung
10	1	9515137	Montagebøsning f. Ø100 mm M-sko	Assembly bush f. Ø100 mm piston	Montagebuchse f. Ø100 mm Kolben
20	1	9597820	Nylon Montagebøsning f. Ø100 mm M-sko	Nylon Assembly bush f. Ø100 mm Piston	Nylon Montagebuchse f. Ø100 mm Kolben
30	1	31753	O-ring 5,7x 94,2	O-ring 5,7x 94,2	O-ring 5,7x 94,2
40	1	9515138	Montagetop Ø84x252;DC=Ø102	Mounting top Ø84x252;DC=Ø102	Montagetop Ø84x252;DC=Ø102
50	1	9515136	Montagebøsning f. ø65mm Stang	Assembly bush f. Ø65 mm Rod	Montagebuchse f. ø65 Stange
60	1	9597822	Kalibreringsbøsning ø100	Calibration bushing ø100	Kalibrerings Buchse ø100
70	1	9515166	Montagenøgle for AF=68	Mounting key for AF=68	Montageschlüssel für SW=68
80	1	34762	Slangesæt for olietømning	Oil drain hose kit	Ölablassschlauch-Kit
90	2	63295	Mejsel 1	Chisel 1	Meißel 1
100	2	63065	Mejsel 2	Chisel 2	Meißel 2

